

2. Describe your community service/volunteer activities (identify roles and accomplishments, and include dates).

[This area contains a large grid of dotted lines for writing.]

3. Describe any work you performed for pay (identify responsibilities and accomplishments).

[This area is a large, empty grid of small squares, intended for the applicant to describe their work experience.]

YOUR PLANS

4. Provide the name and location of the college or university you will attend, and the date you will begin.

[This area is a large, faint, dotted grid intended for the applicant to provide their response to question 4.]

5. What are your educational and career goals related to **architecture, landscape architecture, interior design, or engineering?** (300 words or less)

[A large, empty rectangular area with a light gray dotted grid pattern, intended for the applicant to write their response to question 5.]

6. What excites or interests you most about the prospect of helping to create the built environment?
(300 words or less)

[A large, empty, dotted rectangular area intended for the applicant to write their response to question 6.]

WHY THIS SCHOLARSHIP

7. Please tell us why this scholarship is important to you (250 words or less).

[A large, faint, dotted rectangular area intended for the applicant to write their response to question 7.]

YOUR REFERENCES

Please provide the names of two people, neither family nor personal friends, who will provide recommendations for you. Please see the **SMMA Fund Recommendation Form**.

Name/Relationship:

Name/Relationship:

YOUR HIGH SCHOOL TRANSCRIPT

Please ask your school to provide your high school transcript directly to **SMMA by Friday, March 22, 2024**.

Request that your school send your official transcript to the following address:

SMMA
1000 Massachusetts Avenue
Cambridge, MA 02138
Attention: Heather McCormack

APPLICANT'S CHECK LIST

- I read the description of the SMMA Fund Scholarship Program
- I completed the Application Form
- At least 30 days prior to due date, I requested Recommendation Forms from two people and provided them with a copy of the SMMA Fund Recommendation Form to be filled and sent to SMMA by **Friday, March 22, 2024**.
- At least 30 days prior to the due date, I requested an official transcript from my high school be sent directly to SMMA.

Please sign the following release so that SMMA may access and/or confirm information if necessary.

I authorize the SMMA Fund Scholarship Committee to review my application materials for this scholarship program and release academic and other pertinent information needed to determine my eligibility and qualifications.

Signature:

Date:

The SMMA Fund Scholarship Program reflects SMMA's commitment to the communities it serves, demonstrates SMMA's belief in higher education, and supports the design professions. The program provides financial assistance to high school seniors in the form of scholarships awarded for their continued education in a field of design that contributes to the built environment. **Eligible applicants must plan to enroll in an accredited, not-for-profit, educational institution in the United States to pursue study in Architecture, Landscape Architecture, Interior Design, or one of the following engineering disciplines: HVAC, Electrical, Plumbing, Fire Protection, Structural, or Civil.**

Please assist the SMMA Fund Scholarship Committee by providing your insights into the applicant's activities, accomplishments, and characteristics that position him/her for success. **Please complete this form and submit it by Friday, March 22, 2024** by email to hmcormack@smma.com or by mail to: SMMA, 1000 Massachusetts Avenue, Cambridge, MA 02138, Attention: Heather McCormack.

Applicant's Name: *Johnathan M. ...*

Applicant's Address: *100 ...*

Applicant's High School: *...*

1. Tell us how long you have known the applicant and in what capacity.

[Large dotted area for handwritten response to question 1]

2. Help us understand the applicant's likely success in higher education and the design professions by rating his/her demonstration of the following attributes and providing comments as you wish. **Rate on a scale of poor to excellent.**

<u>Attribute</u>	<i>poor</i>	<i>fair</i>	<i>good</i>	<i>very good</i>	<i>excellent</i>	<u>Comments</u>
Leadership	<input type="checkbox"/>	<input type="checkbox"/>	<input type="checkbox"/>	<input type="checkbox"/>	<input type="checkbox"/>	
Creativity	<input type="checkbox"/>	<input type="checkbox"/>	<input type="checkbox"/>	<input type="checkbox"/>	<input type="checkbox"/>	
Collaboration	<input type="checkbox"/>	<input type="checkbox"/>	<input type="checkbox"/>	<input type="checkbox"/>	<input type="checkbox"/>	
Initiative	<input type="checkbox"/>	<input type="checkbox"/>	<input type="checkbox"/>	<input type="checkbox"/>	<input type="checkbox"/>	
Enthusiasm	<input type="checkbox"/>	<input type="checkbox"/>	<input type="checkbox"/>	<input type="checkbox"/>	<input type="checkbox"/>	
Dependability	<input type="checkbox"/>	<input type="checkbox"/>	<input type="checkbox"/>	<input type="checkbox"/>	<input type="checkbox"/>	

3. Provide any other information or observations about the applicant that might assist the committee in its deliberations.

[Large dotted area for providing information or observations]

Printed Name: [Dotted box]

Email Address: [Dotted box]

Phone Number:

Signature:

Date:

A Charitable organization established by the directors of SMMA to support the communities that SMMA serves and the charitable activities of its employees.

Eligibility

The applicant must be a senior at one of the following high schools in Massachusetts:

- Ayer-Shirley Bedford
- Bridgewater-Raynham Chelsea
- Dennis-Yarmouth Douglas
- East Longmeadow Grafton
- Hudson Lexington
- Lynn Classical Marblehead
- Mashpee North Middlesex Quincy
- Somerville Swampscott
- Tewksbury Memorial Turners Falls
- Wakefield Waltham
- Wellesley West Springfield
- Winchester



Waltham High School

The SMMA is a charitable organization established by the directors of Symmes Maini & McKee Associates, Inc. to support the communities that SMMA serves and the charitable activities of its employees. The Fund provides assistance to organizations and individuals through scholarships and grants.

The SMMAFund Scholarship Program reflects SMMA's commitment to the communities it serves, demonstrates SMMA's belief in education, and nurtures the design professions. The program provides financial assistance to high school seniors in the form of scholarships awarded for their continued education in a field of design that contributes to the built environment.

Eligibility

Eligible applicants must plan to enroll in an accredited, not-for-profit, educational institution in the United States to pursue study in Architecture, Landscape Architecture, Interior Design, or one of the following engineering disciplines: HVAC, Electrical, Plumbing, Fire Protection, Structural, or Civil.

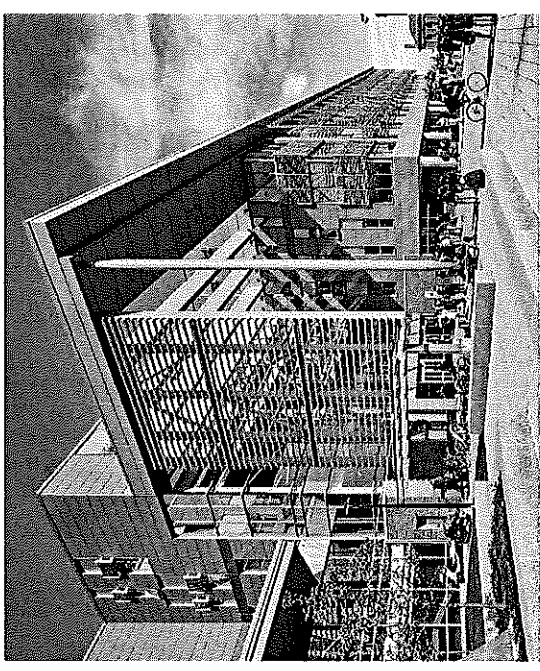

Somerville High School

Process and Criteria

Following a screening process, final selection will be based on academic excellence, clarity of goal, and professional promise.

To apply for this program, students must have the completed Application and Recommendation forms along with their school transcript sent to SMMA by the Friday, March 22, 2024 deadline.

Contact

Heather McCormack
SMMA
1000 Massachusetts Avenue
Cambridge, MA 02138

Forms

To obtain a copy of the Application and Recommendation forms, please see your Guidance Department or email Heather McCormack at hmccormack@smma.com.